

0800
843024

www.farmquip.co

FARMQUIP

ANIMAL MANAGEMENT SOLUTIONS

100%
New Zealand
owned and
operated

Farmhand Round Hay Feeder

- Large bale, 2m diameter
- 15 head positions



Farmhand Heavy Duty Round Feeder

- Large bale, 2m diameter
- 1200mm high
- 9 head positions



Farmhand Lifestyler Hay Feeder

- Hangs on railed fence or gate
- 467H x 454 W x 270 deep



Hanging Hayfeeder with Lid

- Flip top lid keeps hay dry
- Bottom tray minimises hay wastage



HAYFEEDERS = REDUCE BALE WASTAGE
AVAILABLE THROUGH FARMLANDS STORES NATIONWIDE

Large Round Bale Cradle Feeder

- 2250 W x 1780 L x 1200 H
- Drop down sides for calves



\$1,195.00 +GST PLUS FREIGHT

Sheep/Calf Small Bale Cradle Feeder

- 1650 L x 1440 W



\$695.00 +GST PLUS FREIGHT **WHILE STOCKS LASTS**

Large Square Bale Cradle Feeder

- 2900L x 1500W x 1080 H



\$895.00 +GST PLUS FREIGHT

Rectangular Hay Bale Feeder

- Fits 2 large bales



\$995.00 +GST PLUS FREIGHT

WHILE STOCKS LASTS

FARMING IS EASIER WITH FARMQUIP



ShelterShed 3m x 3m

Shelter for:

Calves, horses, sheep, lambs, alpacas

Storage for:

Hay, farm implements, bikes and more!

- Kitset, easy bolt together design, quick to install
- Comes with steel colour cladding for roof and 3 sides
- Heavy duty 50 x 50 RHS galvanised steel frame
- Lower walls clad with 18mm plywood insert
- 3000mm W x 3000mm D x 2200mm H



\$3,195.00 +GST EXCL FREIGHT

ShelterShed 4m x 4m

- Ideal for horses
- Heavy duty 50 x 50 RHS galvanised frame
- Easybolt together design
- quick to install
- Comes with steel cladding for roof and three sides

USE FOR STORAGE OR ANIMAL SHELTER

\$4,795.00 +GST EXCL FREIGHT



0800 843 024

www.farmquip.co

SHEEP MANAGEMENT

Crutch and Weigh Combo Sheep Handler

The best all round sheep handler in the market!

THE ONLY AUTOMATED SHEEP HANDLER AVAILABLE THAT GIVES FULL ACCESS TO FEET & BELLY

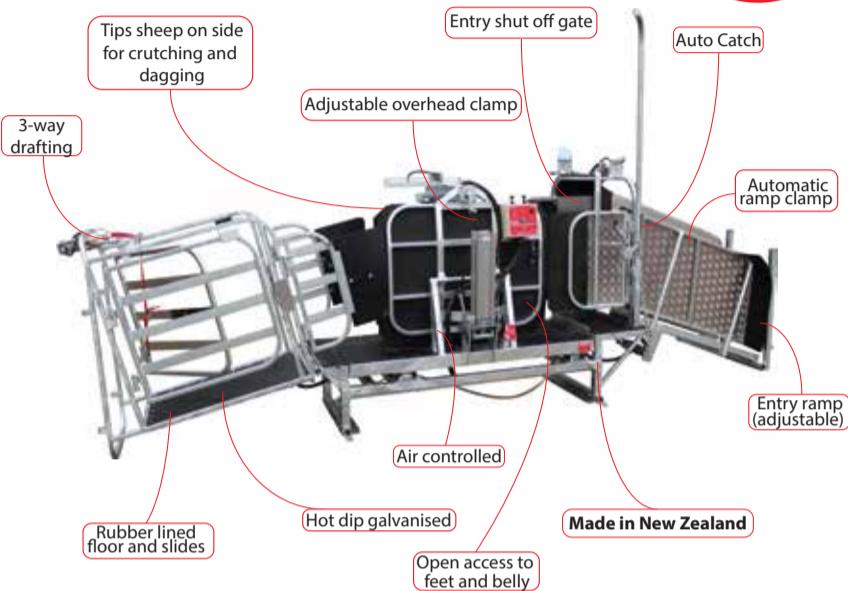

FINANCE AVAILABLE

*Scales sold separately. Optional extras: Ramp clamp, Belly flap, Transport kit.

Daggers Mate Sheep Handler

- The ultimate machine for fast and efficient dagging and crutching
- Air controlled on skids
- Tips sheep on their sides for dagging and crutching
- Adjustable overhead clamp
- Made in New Zealand

CALL US FOR A QUOTE



Optional extras: Belly flap, Transport kit.

Sheep Weigh Crate

- Manual weighing and 3 way drafting
- Alloy, lightweight, transportable
- Mounts on to any existing loadbars



\$2,495.00 +GST

FARMING IS EASIER WITH FARMQUIP



3 Way Draft Module



- Fit into any existing sheep yard

\$1,595.00 +GST

3 way Adjustable Sides Draft Module



- Fit into any existing sheep yard

\$4,495.00 +GST

3 Way Fixed-V Sided Draft Module



- Fit into any existing sheep yard

\$3,295.00 +GST

Portable Alloy Sheep Ramp

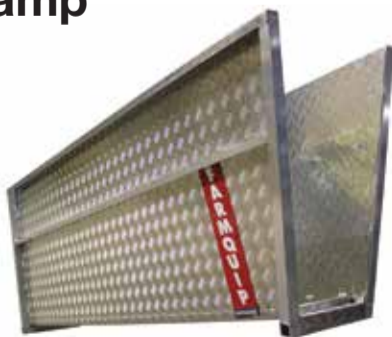

2400mm \$2,990.00 +GST
3000mm \$3,990.00 +GST

Woolaway Lift & Swing Gates



FROM \$895.00 +GST PLUS FREIGHT

Sheep Race Anti-Backing Flaps



PAIR \$159.00 +GST PLUS FREIGHT

SHEEP MANAGEMENT

30 Head Sheep Yard

- Heavy duty steel, hot dip galvanised
- Includes sheep draft module
- Kitset delivered to main depot

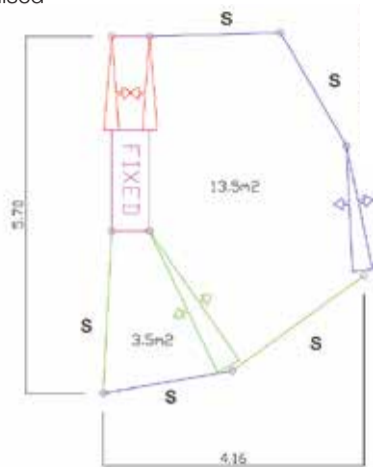

\$5,990.00
+GST

50 Head Sheep Yard

- Heavy duty steel, hot dip galvanised
- Includes sheep draft module
- Kitset delivered to main depot

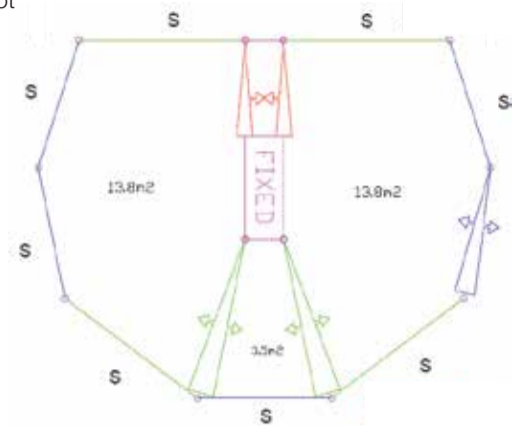

\$7,990.00
+GST

100 Head Sheep Yard

- Heavy duty steel, hot dip galvanised
- Includes sheep draft module
- Kitset delivered to main depot

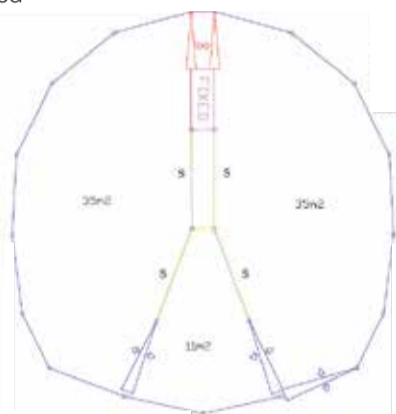

\$11,500.00
+GST

150 Head Sheep Yard

- Heavy duty steel, hot dip galvanised
- Includes sheep draft module
- Kitset delivered to main depot

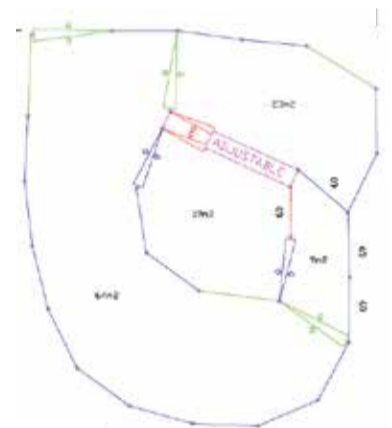

\$13,990.00
+GST

FARMING IS EASIER WITH FARMQUIP



710 Head Sheep Yard

- Heavy duty steel, hot dip galvanised
- Includes sheep draft module
- Kitset delivered to main depot

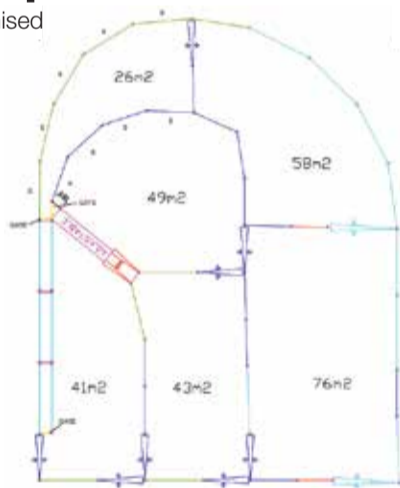

\$24,990.00
+GST

1,250 Head Sheep Yard

- Heavy duty steel, hot dip galvanised
- Includes sheep draft module
- Kitset delivered to main depot

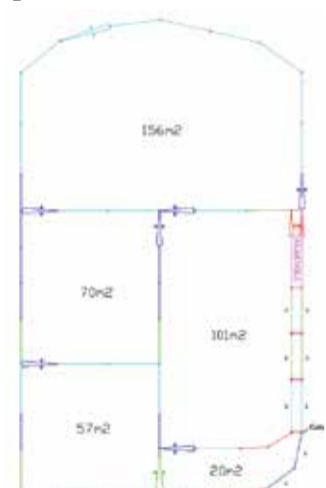

\$27,990.00
+GST

Sheep/Calf Panels

- Railed - 3m W x 1m H
- Quick, easy pin together yard panel for a variety of uses
- Use for sheep/calves/goats



\$179.00
+GST EACH

**OR
4 FOR
\$699.00**

Sheep Shears

- Battery powered
- 180watt, 12 volt
- 2800 RPM
- Includes combs, cutters, charger, 2 x batteries and carry case.



**AVAILABLE
AT
FARMLANDS
NATIONWIDE**

CATTLE HANDLING

COST EFFECTIVE YARDS FOR LIFESTYLE TO LARGE FARMS

Farmhand 5 Head Yard

- 7-rail multi-purpose for cattle and sheep
- Farmhand walkthrough headbail
- Farmhand sliding gate
- Hot dipped galvanised
- Kit set delivered to main depot



(Approximately 5 head yard size, depending on animal size)

\$5,290.00 +GST

Farmhand 10 Head Yard

- 7-rail multi-purpose for cattle and sheep
- Farmhand walkthrough headbail
- Farmhand sliding gate
- Hot dipped galvanised
- Kit set delivered to main depot



(Approximately 10 head yard size, depending on animal size)

\$5,990.00 +GST

Farmhand 20 Head Yard

- 7-rail multi-purpose for cattle and sheep
- Farmhand walkthrough headbail
- Farmhand sliding gate
- Hot dipped galvanised
- Kit set delivered to main depot



(Approximately 20 head yard size, depending on animal size)

\$7,990.00 +GST

Farmhand 25 Head Yard

- 7 rail multi-purpose for cattle and sheep
- Farmhand walkthrough headbail
- Farmhand sliding race gate
- Hot dipped galvanised
- Kit set delivered to main depot

Excludes loading ramp. Add loading ramp for \$3,595.00 + GST (Plus freight)

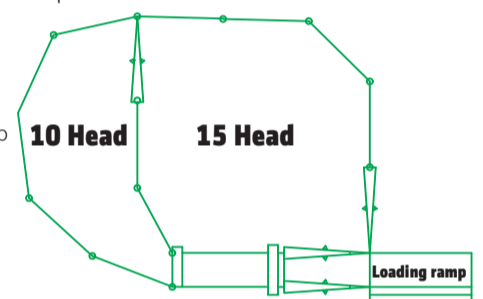

(Approximately 25 head yard size, depending on animal size)

\$9,990.00 +GST

Farmhand 42 Head Yard

- 7-rail multi-purpose for cattle and sheep
- Farmhand walkthrough headbail
- Farmhand sliding gate
- Hot dipped galvanised
- Kit set delivered to main depot

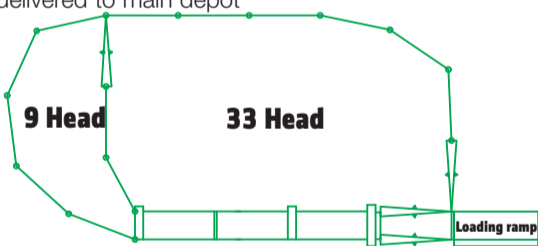

\$13,990.00 +GST
Excludes loading ramp. Add loading ramp for \$3,595.00 + GST (Plus freight)

Farmhand 75 Head Yard

- 7 rail multi-purpose for cattle and sheep
- Farmhand walkthrough headbail
- Farmhand sliding race gate
- Hot dipped galvanised
- Kit set delivered to main depot

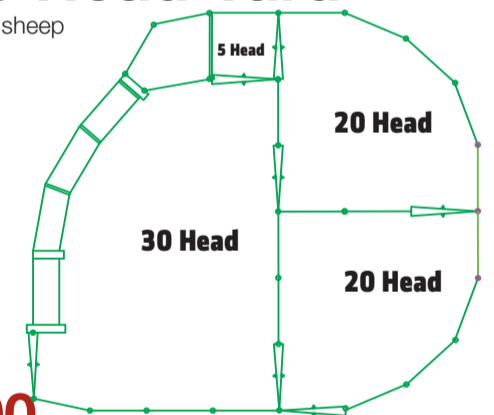

\$19,990.00 +GST

Farmhand 126 Head Yard

- 7 rail multi-purpose for cattle and sheep
- Farmhand sliding race gate
- Hot dipped galvanised
- Kit set delivered to main depot

INCLUDES FARMHAND VETLESS CRUSH

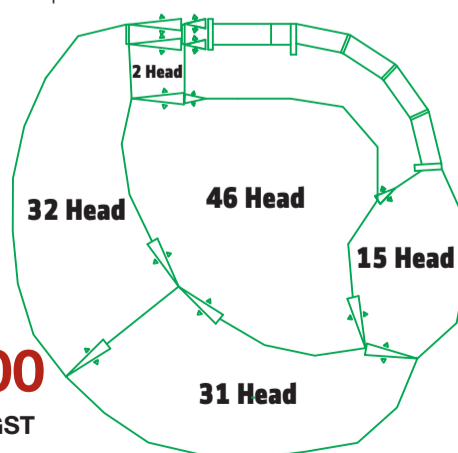

\$34,990.00 +GST

(Approximately 126 head yard size, depending on animal size)

Farmhand 150 Head Yard

- 7-rail multi-purpose for cattle and sheep
- Farmhand sliding gate
- Hot dipped galvanised
- Kit set delivered to main depot

INCLUDES FARMHAND VETLESS CRUSH

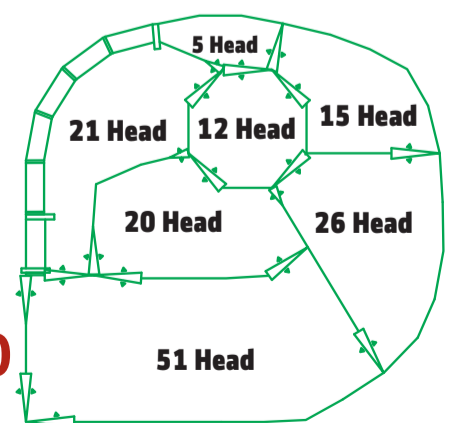

\$36,990.00 +GST

(Approximately 150 head yard size, depending on animal size)

CATTLE HANDLING

Farmhand Handler

With walkthrough headbail

- Great for lifestyle blocks or small farms needing an economical cattle handling area
- Headbail and railed sides



\$3,990.00 +GST

Add side gate for \$400.00+ GST

Farmhand Vetless Crush

- Economical crush for weighing and handling
- Farmhand walkthrough headbail
- 50 x 50
- One piece gates on both sides
- Hot dip galvanised
- Heavy duty steel floor
- Single sliding entry door



\$5,995.00 +GST

Farmhand Loading Ramp

- Adjustable height platform



\$3,795.00 +GST +FREIGHT

Stockmaster Vet Crush

- Economical crush for weighing and handling
- Stockmaster walkthrough headbail
- Extra heavy duty 75 x 50 base frame
- Split gates on both sides
- Hot dip galvanised
- Heavy duty steel floor
- Single sliding entry door
- Vet access gates
- Made in New Zealand



\$9,890.00 +GST

FARMING IS EASIER WITH FARMQUIP



Calf Weigh Crate

- Weighs calves up to 120kg



\$3,495.00 +GST PLUS FREIGHT

Calf Mate Auto Drafter

- Designed for fast efficient weighing and 3-way drafting for large herds
- Auto weighing and drafting
- Weighs up to 160kg



\$13,595.00 +GST

Calf/Sheep Panels

- Railed - 3m W x 1m H
- Quick, easy pin together yard panel for a variety of uses
- Use for sheep/calves/goats



OR 4 FOR \$699.00

\$179.00 +GST EACH

Sliding Yard Gate

- Including mounting brackets



\$950.00 +GST PLUS FREIGHT

Stockman Headbail



\$3,595 +GST PLUS FREIGHT

Stockmaster Headbail



\$2,795.00 +GST PLUS FREIGHT

Farmhand Walkthrough Headbail



\$1,595.00 +GST PLUS FREIGHT

Farmhand Swingbail



\$995.00 +GST PLUS FREIGHT

THE RURAL BUTCHER



Rural Mincer T12

- Make mince from home
- Stainless steel body
- 750W motor
- Capacity 150kg/h



\$599.00
+GST

SKU
BU08

Rural Mincer T22

- Make mince from home
- Stainless steel body
- 850W motor
- Capacity 250kg/h



\$999.00
+GST

SKU
BU09

Rural Sausage Filler 7L

- Make sausages at home



\$344.00
+GST

SKU
BU10

Rural Sausage Filler 3L

- Make sausages at home



\$257.00
+GST

SKU
BU13

Rural Meat Slicer

- Slice meat to perfection every time.
- Suitable for home, to semi-professional use.



\$799.00
+GST

SKU
BU94

Rural Meat Mixer

- Easy mixing handle and pivoting cradle with lid.



\$478.00
+GST

SKU
BU14

Burger Pattie Press

- 130mm diameter



\$260.00
+GST

SKU
BU132

Double Burger Pattie Press

- 130mm diameter



\$25.00
+GST

SKU
BU131

SPEND OVER \$300+GST ON BUTCHERY ITEMS & RECEIVE A FREE BUTCHERS APRON!*



Small Meat Saw

- Throat size 270mm H x 200mm W
- 1.1kW motor
- 210mm alloy pulley wheels
- Table 500 x 600mm



\$1,090.00
+GST

SKU
BU91

Medium Meat Saw

- Throat size 380mm H x 250mm W
- 1.5kW motor
- 260mm alloy pulley wheels
- Table 700 x 550mm



\$2,250.00
+GST

SKU
BU92

Large Meat Saw

- Throat size 460mm H x 285mm W
- 1.5kW motor
- 300mm alloy pulley wheels
- Table 700 x 550mm



\$3,199.00
+GST

SKU
BU93

Rural Meat Saw

- The original farmers meatsaw
- Throat size 320 x 250mm
- 3/4HP enclosed motor
- 250mm alloy pulleys
- Cutting guides



\$2,595.00
+GST

SKU
BU01

Stainless Steel

- 1200 L x 600 D



\$551.00
+GST

SKU
BU82

Corner Bench Unit

- 900 x 900



\$459.00
+GST

SKU
BU83

Stainless Steel Workbench

- 1200 L x 600 D



\$373.00
+GST

SKU
BU80

Butchers Block Workbench

- 900 L x 600 D



\$629.00
+GST

SKU
BU81

THE RURAL BUTCHER

11 pc Butcher Knife Set QUALITY STEEL BLADES

- Ergonomic polpropylene antimicrobial handles



\$199.00
+GST

SKU
BU45

8 pc Butcher Knife Set QUALITY STEEL BLADES

- Ergonomic polpropylene antimicrobial handles



\$159.00
+GST

SKU
BU44

2 pc Filleting Knife Set QUALITY STEEL BLADES

- Ergonomic polpropylene antimicrobial handles



\$60.00
+GST

SKU
BU97

6 pc Butchery BBQ Knife Set QUALITY STEEL BLADES

- Ergonomic polpropylene antimicrobial handles



\$129.00
+GST

SKU
BU47

6 pc Chef Knife Set QUALITY STEEL BLADES

- Ergonomic polpropylene antimicrobial handles



\$129.00
+GST

SKU
BU43

Farmers Skinning Knife & Sheath Set

- 6" steel
- Leather sheath
- Skinning knife



\$79.00
+GST

SKU
BUKIT

SPEND OVER \$300+GST ON BUTCHERY ITEMS & RECEIVE A FREE BUTCHERS APRON!*



Stockinette

- 500g/2.5kg option
- 100% cotton



500g **\$24.00**
+GST 2.5kg **\$85.00**
+GST

SKU
BU137/138

Cool Chief 24L Portable Fridge

- 24 Litre Capacity Semiconductor Car Fridge
- Easy to read LED digital display



\$329.00
+GST

SKU
BU150

Vacuum Sealer

- Dual power mode for use at home, camping or on the boat
- AC 240V & DC 12V plug



\$229.00
+GST

SKU
BU71

Sealer Bags

- 50 packet
- 150 x 200mm



\$17.00
+GST

SKU
BU73

Sealer Bags

- 3 x rolls
- 200 x 3000mm



\$23.00
+GST

SKU
BU76

Vacuum Sealer Pro

- 220V,900w
- Heat-sealing Power:500w
- Lowest Absolute Pressure:1.33Kpa
- Volume of Vacuum Case:470x435x70mm
- Sealing Strip Size:500x10mm
- Dimension:650x585x565mm
- Weight:52kg

NEW



\$2,795.00
+GST

SKU
BU198

Sealer Bags

- 50 packet
- 280 x 400mm



\$47.50
+GST

SKU
BU75

Sealer Bags

- 3 x rolls
- 280 x 5000mm



\$47.00
+GST

SKU
BU77

Grill Chief Portable BBQ

- Cooking area 460mm x 280mm
- Premium 304 grade stainless steel construction



\$240.00
+GST

SKU
BU151

FOR THE FARM

Bullmax One Man Auger

- Powerful 2-stroke, 52cc engine / 1.45kw
- Commercial quality
- 100mm, 150mm, 200mm drill sizes
- 450mm extension bar
- Recoil spring
- 12 month warranty



\$849.00
+GST

Bullmax Two Man Auger

- Powerful 2-stroke 68cc engine / 1.9 kw
- Commercial quality
- 150mm, 250mm, 300mm drill sizes and replaceable cutting blades
- 450mm extension bar
- Recoil spring
- 12 month warranty



\$990.00
+GST

Bullmax Post Driver

- Powerful 6 x 35 Honda 4-stroke engine
- Includes interchangeable 45mm, 55mm, 73mm & 80mm sleeve heads
- 12 month warranty
- Comes with carry case designed to hold machine and all accessories



\$1,895.00
+GST

Bullmax Electric Compressor

- FAD – 320L/Min AS-4637 approved 15.9 CFM
- Weight: 105kg
- **WHILE STOCKS LAST!**



\$595.00
+GST

Bullmax Petrol Compressor

- FAD – 385L/Min AS-4637 approved 20 CFM
- Weight: 116kg
- **WHILE STOCKS LAST!**



\$895.00
+GST

**HOT
CLEARANCE
PRICE**

*Tabloid offers valid until 31st May 2022. Many products shown are manufactured to order so standard Farmquip leadtimes and freight apply. Freight charged on all orders unless otherwise stipulated. Cattle yards pricing excludes concrete and site works. All products while stocks last and limited stock available. Some products may be unavailable due to shipping delays. Aprons available while stock lasts.



While the weather gets colder the **Lucky Deals** keep coming. It's the last month of **Lucky Autumn** to save heaps in-store and online. We'll also be rolling out our best one-day-only deals yet on 20th May.

MAKE IT THE BEST AUTUMN EVER WITH FARMLANDS.

**15%
OFF**

EXIDE BATTERIES
Multiple SKUs



**SAVE
\$51.55**

SUMMIT BARBED WIRE SOFT
2.5MMx75MM 25KG
OR 2.5MMx150MM 25KG
1001713, 1002923

\$179.95



GALLAGHER HR4 HAND HELD
READER LIMITED EDITION BLACK
1055539

\$999.95

**LIMITED
STOCK**



HANSEN SUPER-FLO
TROUGH VALVE 25MM
1000029

\$29.99
SAVE \$7.99

PLUS 50c from every Super-flo purchased will be donated to

**FREE
RED FLOAT WITH
EACH SUPER-FLO
TROUGH VALVE**
10023487

cure kids
big research for little lives

STALLION RECTANGLE
TROUGH 80L
1000062

\$169.99
SAVE \$97.71



**BE IN TO
WIN ONE OF
TWO HONDA
XR190CT
MOTORBIKES***
*Valid at \$9259

PROMAX XPRESS
WATER TANK 25000L
*Mist Green only, 1041029

\$3,399.99
SAVE \$494.01

**30000L
\$3,949.99
SAVE \$646.01**
1044039



Visit shop.farmlands.co.nz or head in-store today!

*Terms and Conditions apply. Offer valid from 1st May 2022 while stocks last. Visit www.farmlands.co.nz.

Prices valid 1st - 31st May 2022. Prices include GST. Savings and Discounts based on normal retail prices. While stocks last.

**Together
stronger™**

Farmlands
co-operative